

TY□A Type

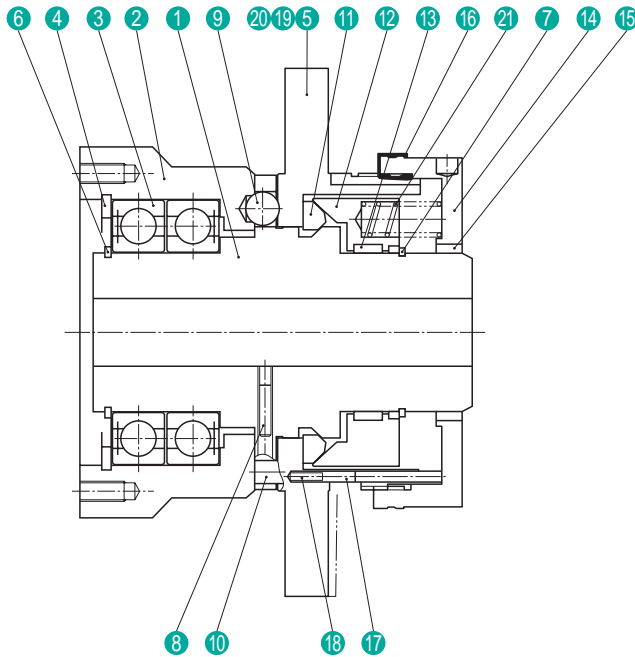

TY30A



● ADOPTION EXAMPLES



HIGH VISCOSITY PUMP

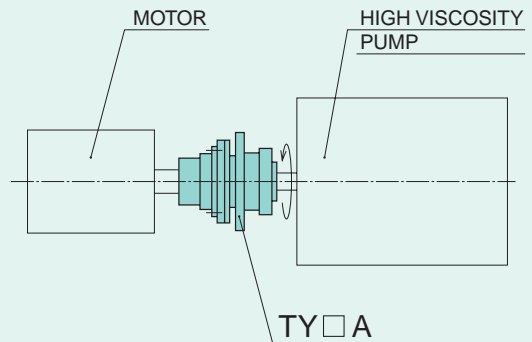

● NAMES OF PARTS

1	Hub boss
2	Flange
3	Bearing
4	C-ring for hole
5	Case
6	C-ring for shaft
7	WR type stopper ring
8	Hexagon socket head setscrew
9	Steel ball
10	Parallel pin
11	Segment
12	Taper ring
13	Slide ring
14	Adjusting ring
15	Metal
16	Clip
17	Pin
18	Spring
19	Model name plate
20	Name plate
21	Spring

*Dimensions and specifications might be changed for improvement without notice.

TY□A Type

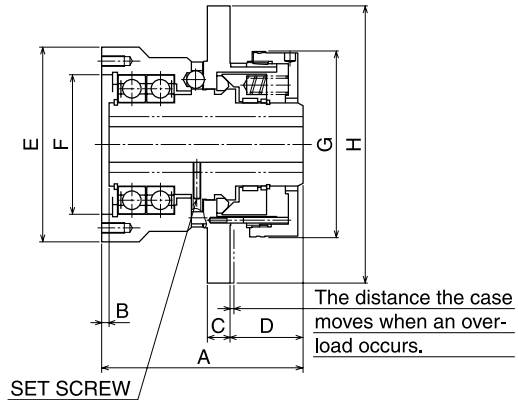
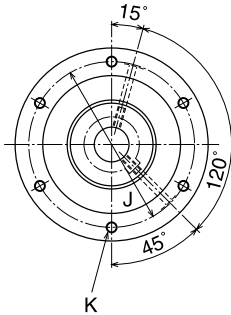

● DIMENSION TABLE

MODEL	A	B	C	D	φE	φF	φG	φH	MOUNTING BOLT	
									J PCD	K BOLT SIZE
TY30A-L · H · G	110	4	12	40.4	105 ⁺⁰ _{-0.035}	75 ^{+0.030} ₋₀	102	150	90	6-M6×12L
TY40A-L · H · G	123	4	12	42.3	130 ⁺⁰ _{-0.040}	95 ^{+0.035} ₋₀	122	175	115	6-M8×16L
TY50A-L · H · G	145	5	16	49.9	155 ⁺⁰ _{-0.040}	115 ^{+0.035} ₋₀	147	210	135	6-M10×20L
TY65A-L · H · G	170	5	20	56.7	198 ⁺⁰ _{-0.046}	150 ^{+0.040} ₋₀	183	250	175	6-M12×24L
TY85A-L · H · G	225	5	20	84.3	258 ⁺⁰ _{-0.046}	200 ^{+0.046} ₋₀	232	330	230	6-M16×32L

● SPECIFICATIONS

MODEL	TORQUE RANGE N·m	SPRING COLOR × QTY	MAX SPEED min ⁻¹	INERTIA MOMENT kg·m ²	WEIGHT kg	MAX HOLE DIA φ mm	STANDARD HOLE DIA φ mm	PREPARED HOLE DIA φ mm	SET SCREW	RELEASE DISTANCE mm
TY30A-L	26 ~ 94	WHITE×16	2,200	9.3×10 ⁻³	5.0	30	30H7×8Js9	19	2-M4	2.4
TY30A-H	43 ~ 170	R E DX 8								
TY30A-G	89 ~ 200	R E DX 16								
TY40A-L	56 ~ 180	WHITE×16	1,800	22×10 ⁻³	8.0	40	40H7×12Js9	24	2-M5	2.8
TY40A-H	67 ~ 400	R E DX 8								
TY40A-G	160 ~ 400	R E DX 16								
TY50A-L	50 ~ 290	WHITE×16	1,800	56.7×10 ⁻³	16.0	50	50H7×14Js9	34	2-M6	3.6
TY50A-H	100 ~ 520	R E DX 8								
TY50A-G	180 ~ 800	R E DX 16								
TY65A-L	110 ~ 440	WHITE×16	1,800	155.2×10 ⁻³	37.0	65	65H7×18Js9	38	2-M10	4.8
TY65A-H	270 ~ 1,200	R E DX 8								
TY65A-G	580 ~ 1,600	R E DX 16								
TY85A-L	290 ~ 1,000	YELLOW×16	1,800	566×10 ⁻³	64.0	85	85H7×22Js9	48	2-M12	5.8
TY85A-H	580 ~ 2,000	R E DX 8								
TY85A-G	1,100 ~ 3,200	R E DX 16								

- The operating torque varies according to the number of springs used.
Up to three springs can be used.

*Dimensions and specifications are subject to change without prior notice.