

Series 601 Product Overview

Features:

- Compact straight line action clamp

Applications:

- Assembly
- Testing
- Soldering
- Gluing

Also Available:

See page 7.1 for accessories

601



601-M



601-O
Straight Base
U-Bar



601-SS
Stainless steel

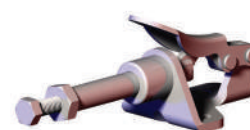

601-OSS ⓘ
Stainless steel
External
thread

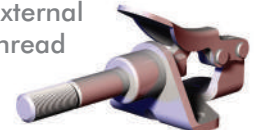

Series 601 Technical Information, Holding Capacities, Standard Clamp Dimensions

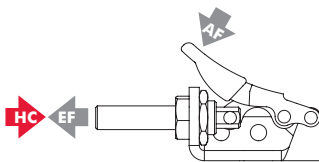

Model	Max. Holding Capacity	Weight	EF:AF (pushing/pulling)	Plunger Travel	(M) Plunger Thread	Spindle (Recommended)	Spindle Included
601					#8-32	105203	Yes
601-M					M4	205208-M	No
601-O	[100 lbf] 440 NXX	[0.09lb] 0,04kg	14:1/25:1	[0.63] 16	1/4-20	--	No
601-SS					#8-32	205943	Yes
601-OSS ⓘ					1/4-20	--	No

ⓘ This item is available upon request HC = Holding Capacity, EF = Exerting Force, AF = Applied Force

